

ST PART NO. _____ PC(S). REQUIRED PER ASSEMBLY _____ STD NO. _____

CODE	ECO#	(DATE)	MADE BY
D	3639	11/03/09	WJR
E	4035	05/25/11	WJR
F	4132	01/06/12	WJR
G	4395	09/17/13	WJR

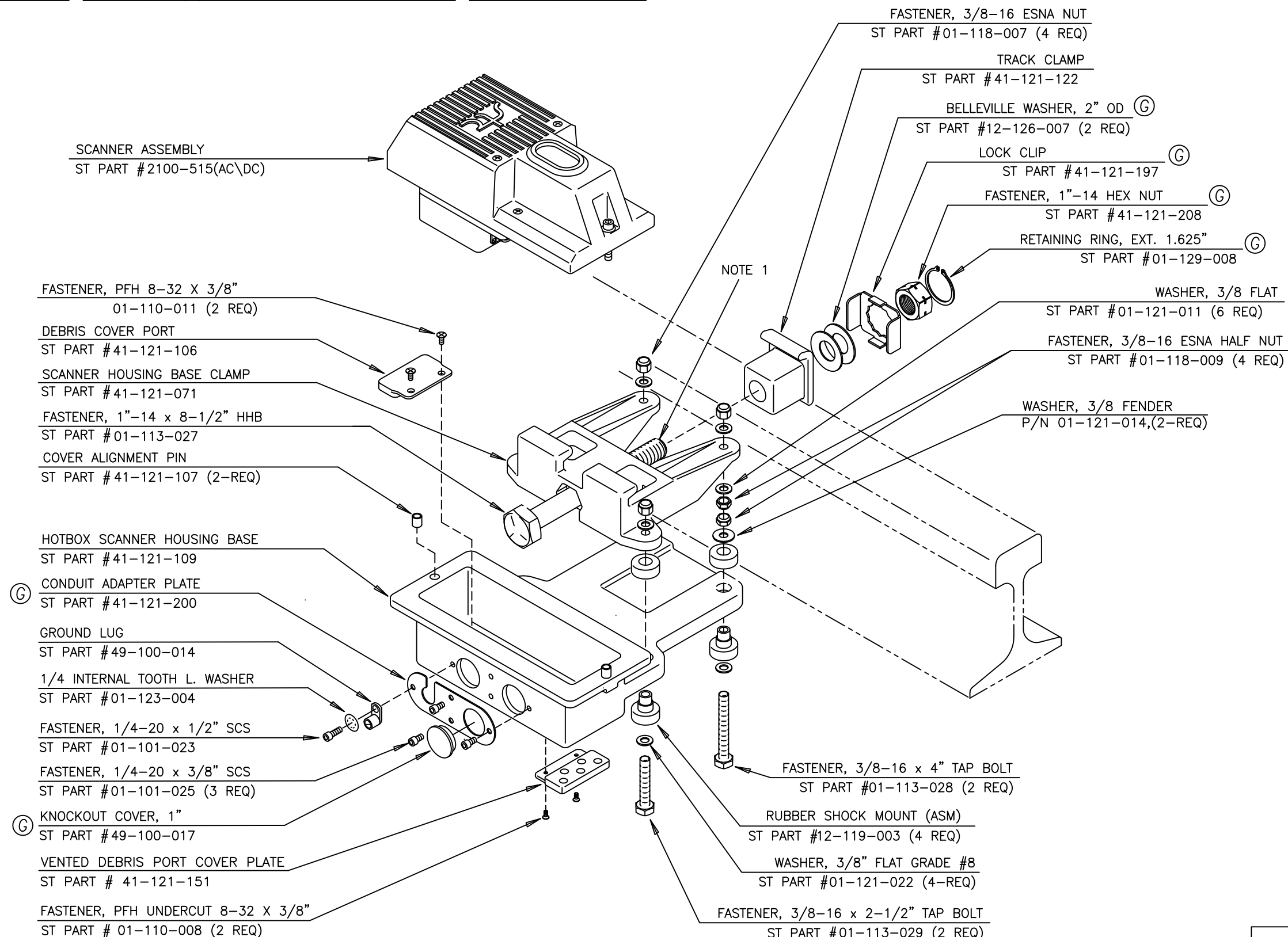

NOTE 1
BRUSH ANTI-SEIZE COMPOUND LIBERALLY ON THE
THREADS OF PIN BEFORE INSTALLING NUTS.

SOUTHERN TECHNOLOGIES CORP			NAME: INBOARD SCANNER ASSEMBLY		SCALE		DATE	
TOLERANCE-UNLESS OTHERWISE SPECIFIED			SERIES: 2100-501 INBOARD SCANNER		DRAWING NO.		ST PART NUMBER	
HOLES (DIA) ±			DRAWN BY: WJR		1 OF 1		ASM2100501	
ANG. ±			APPROVED BY: <i>WJR</i> 9/17/13		MATERIAL:		REV. G	